

Assembly scheme

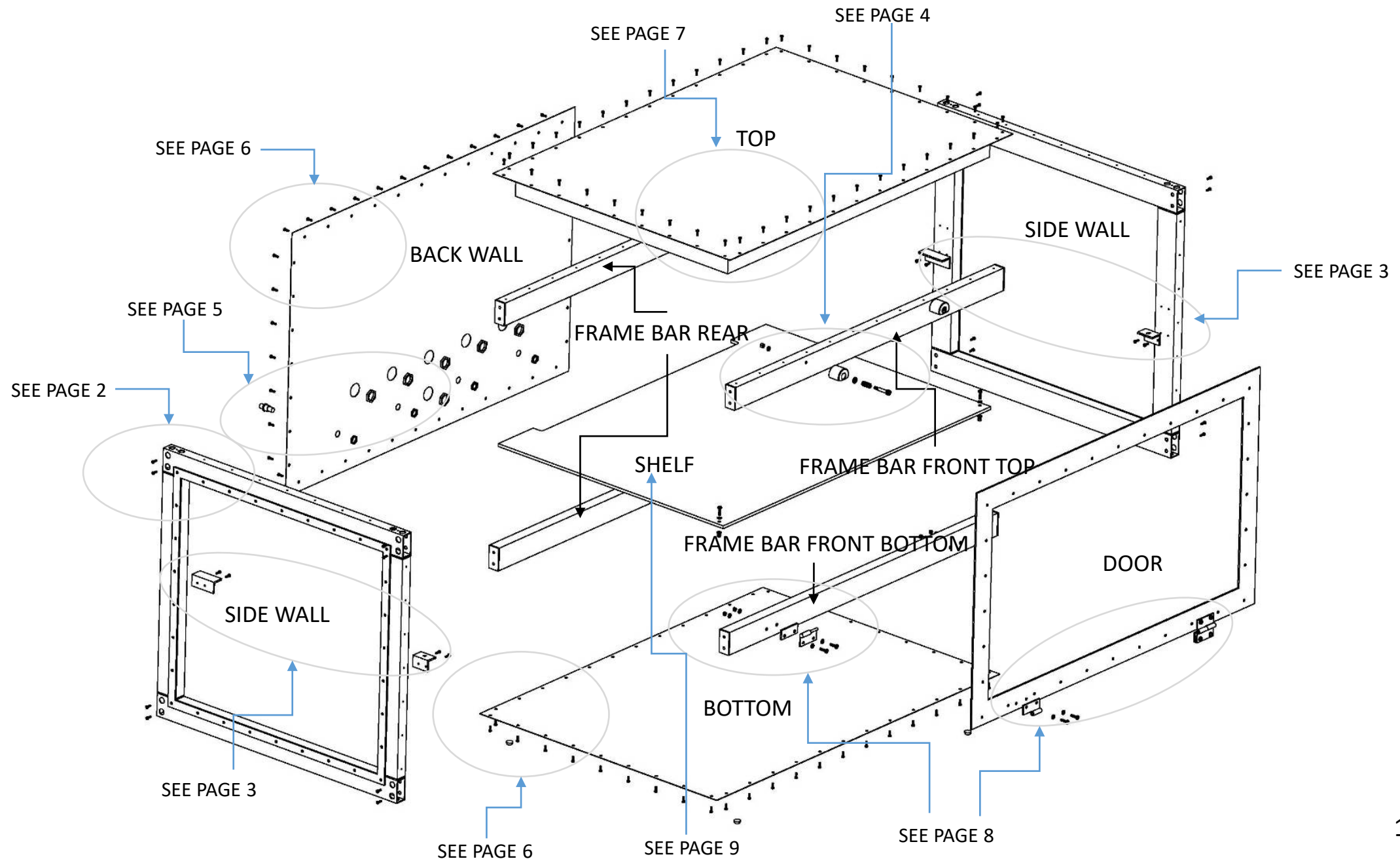

Frame assembly

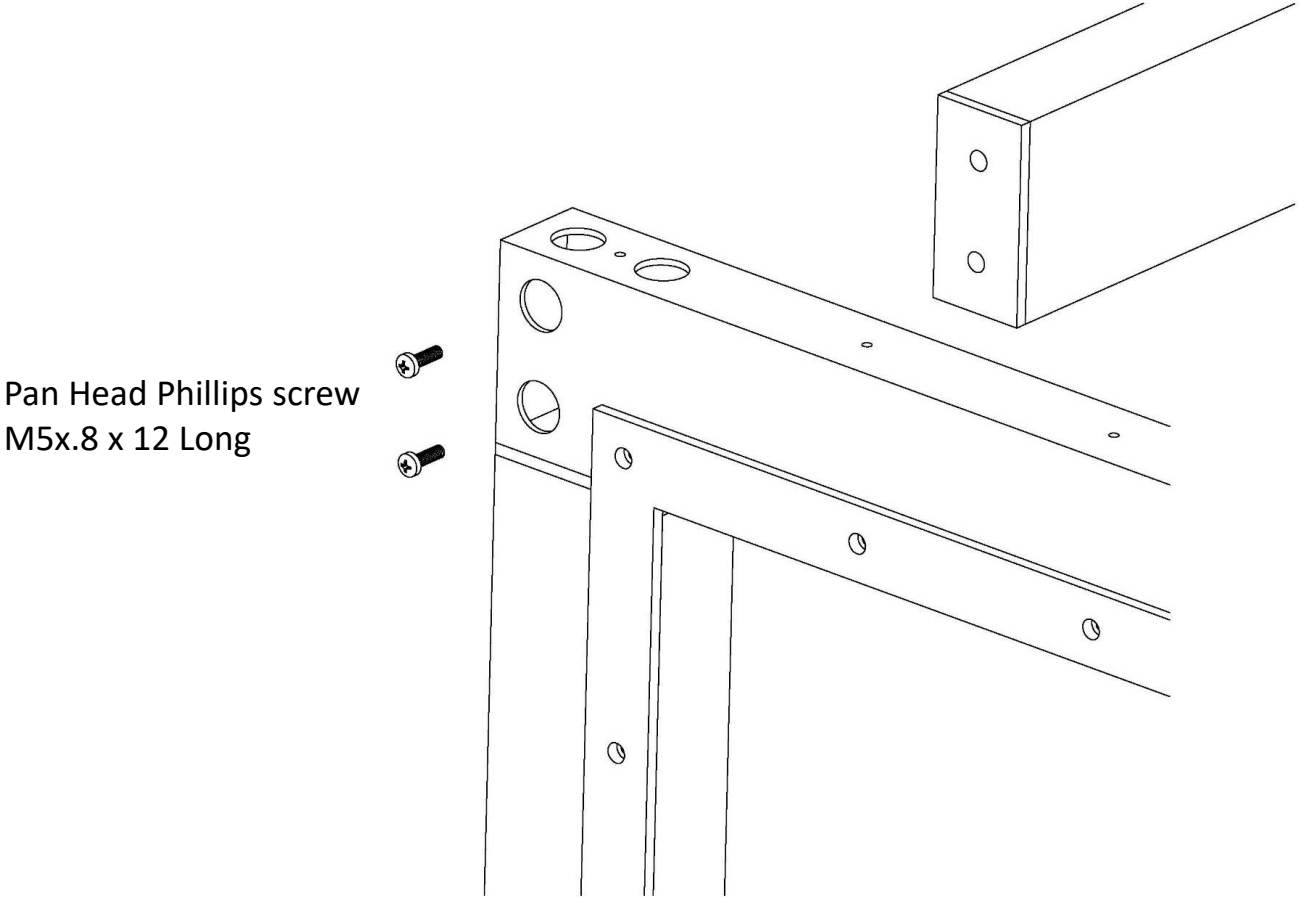

Pan Head Phillips screw
M5x.8 x 12 Long

Assemble frame using two side walls, two rear frame bars, one top-front frame bar, and one bottom-front frame bar. Both front frame bars should be oriented so that their larger holes are facing the inside of the enclosure. Both rear frame bars should be oriented so that their small holes face the outside of the enclosure.

Shelf brackets installation (for customers who purchased FE with the shelf)

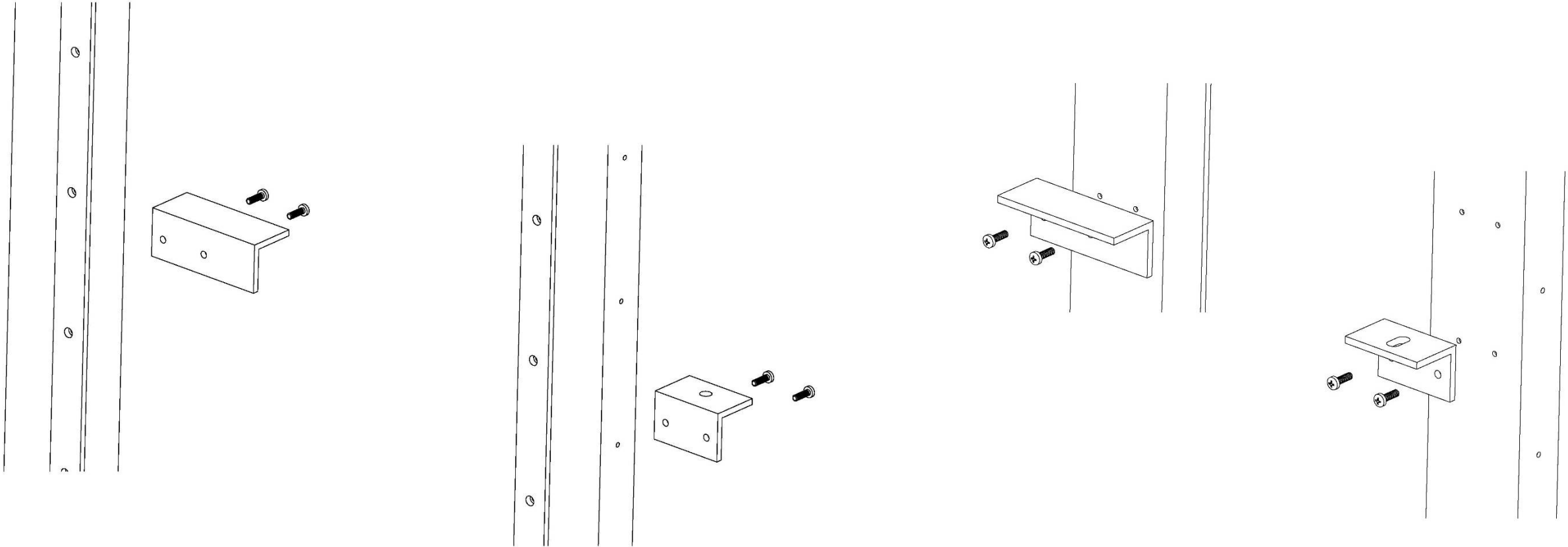

Assemble shelf brackets using strip resistant self tapping screw M3x 10 Long. Front brackets are slotted and a through hole, install as shown.

Doorknob assembly

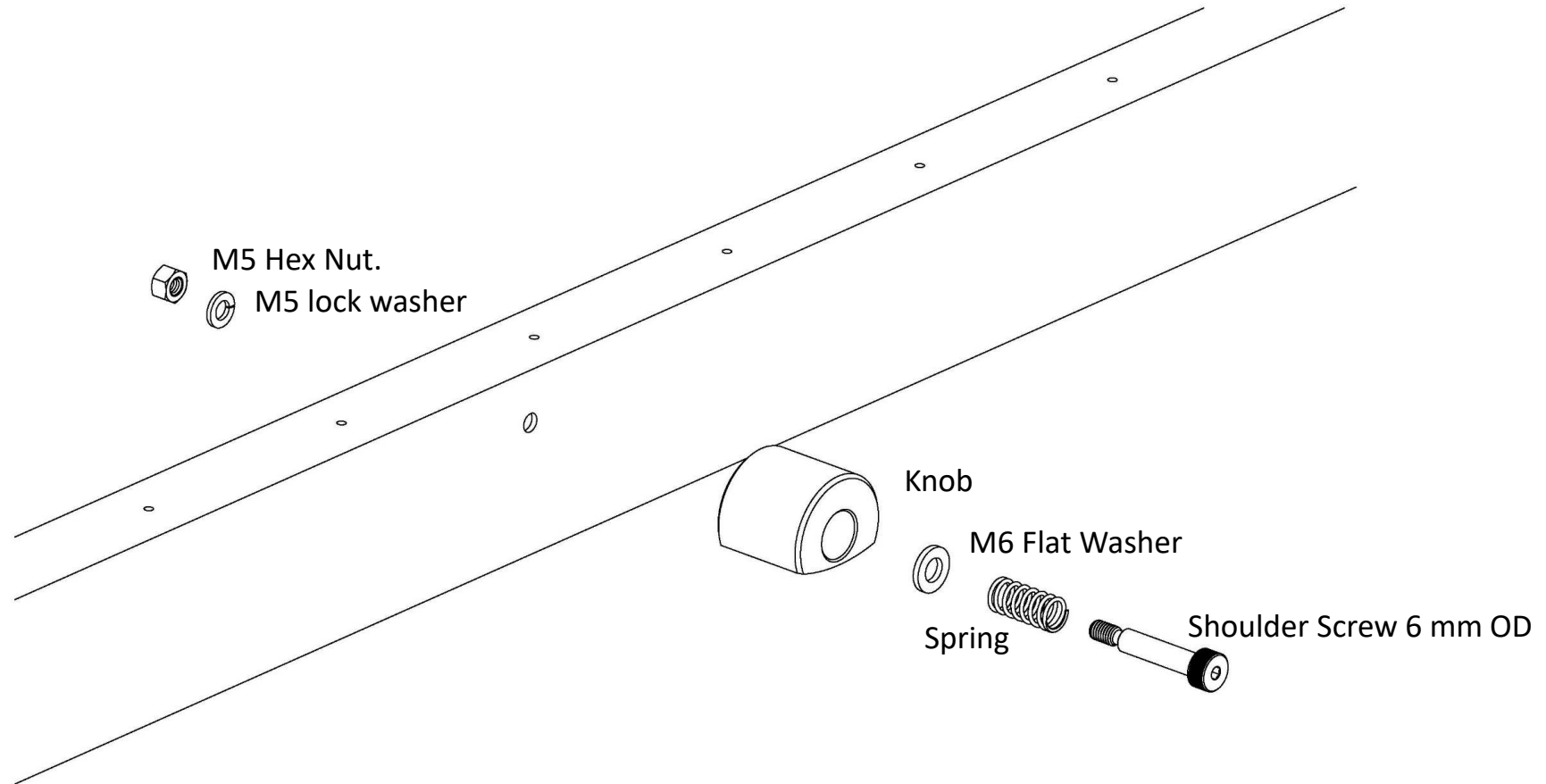

Install the two doorknobs on the top-front frame bar. Slide the spring and M6 flat washer onto the shoulder screw and insert into the knob. Push on the head of the screw until its thread is fully visible on the back side of the knob. Keeping screw pushed in run the threaded part of the screw through the hole on the frame bar and tighten the nut with a lock washer.

Connectors installation

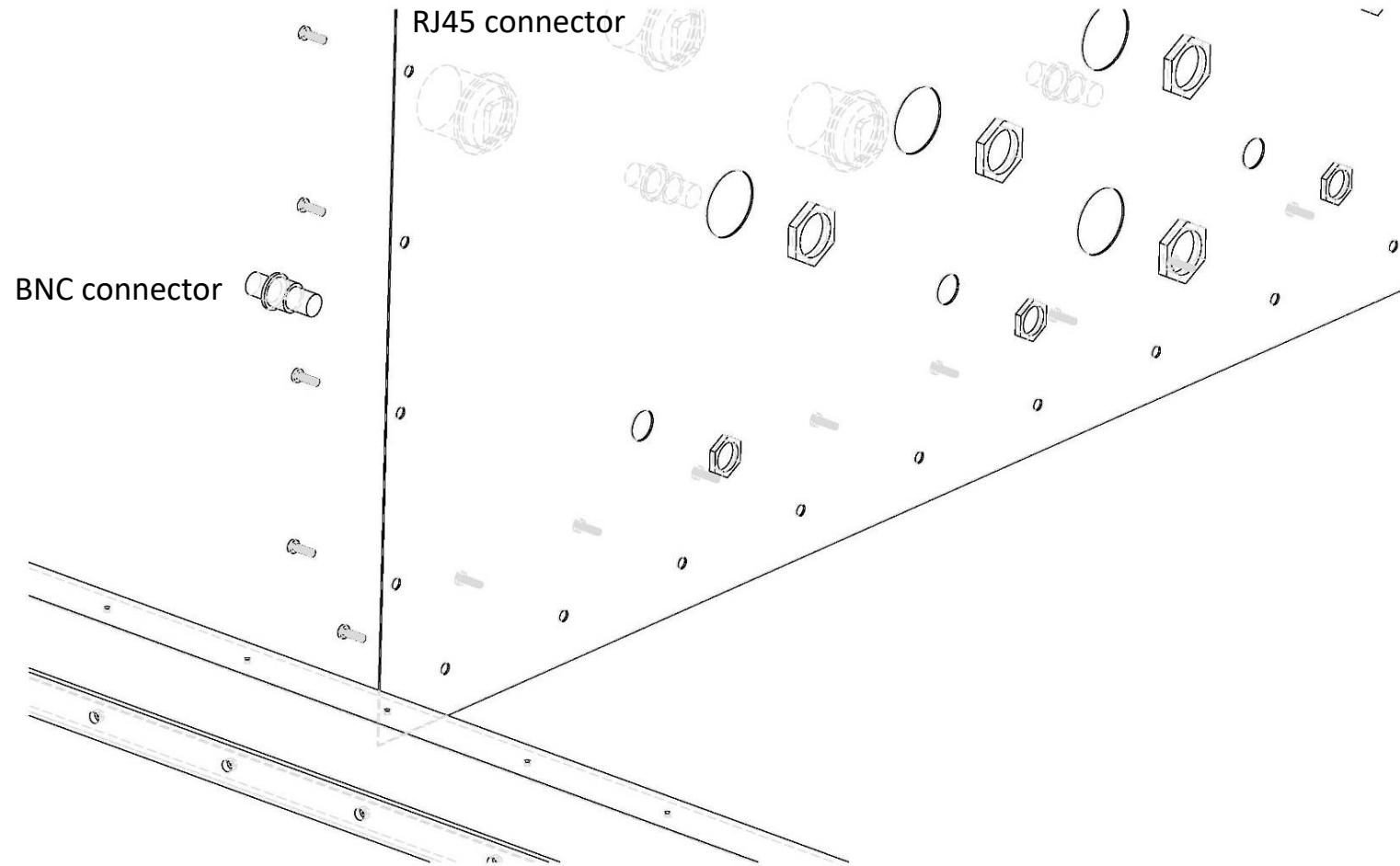

Push feedthrough BNC and RJ45 connectors into corresponding holes at the back wall from outside and secure with nuts from inside.

Floor and back wall installation

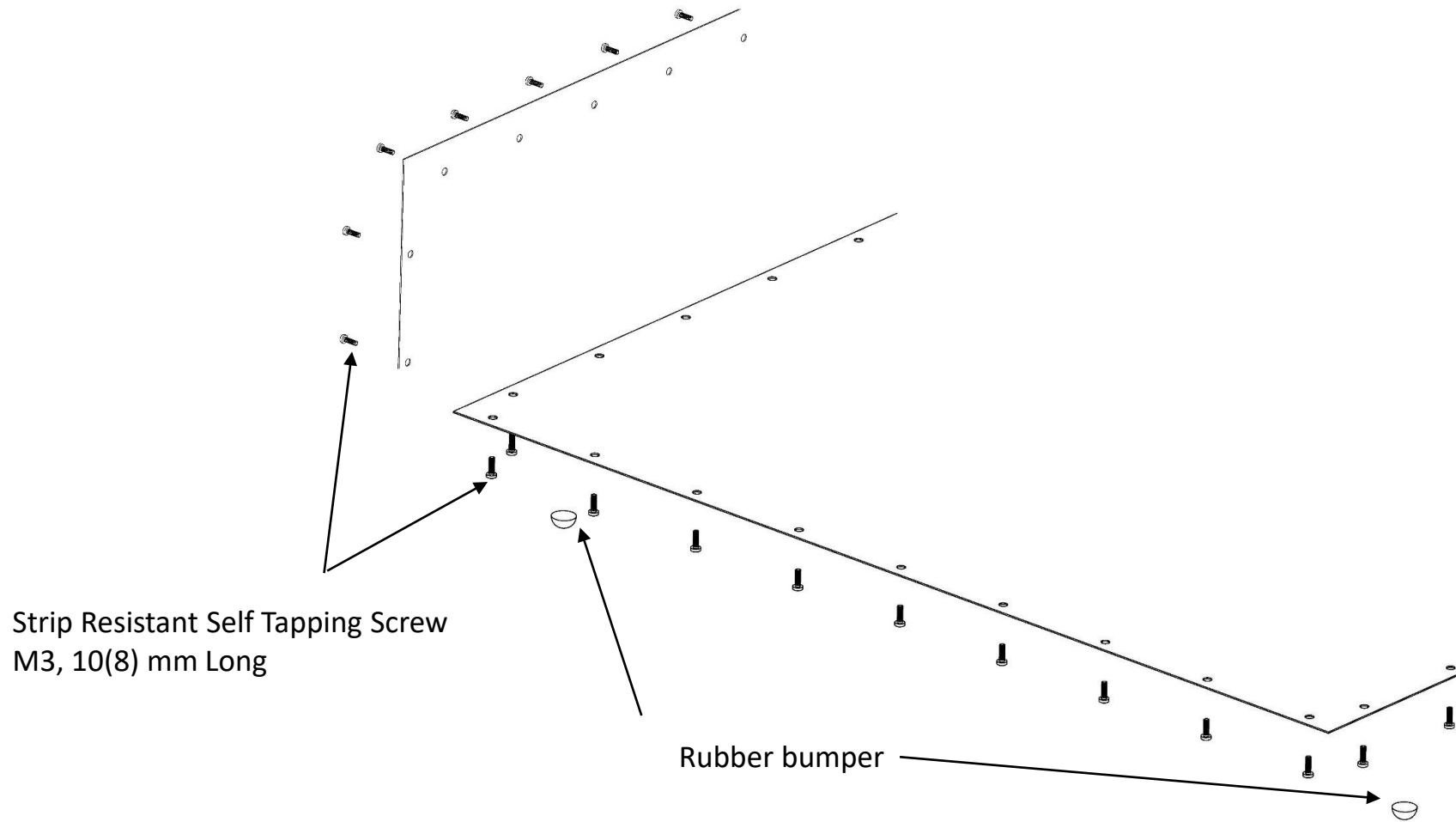

Install the back wall and the floor using self-tapping M3, 10(8) mm long screws. If you use a hammer drill or impact driver to install the screws, do NOT drive screws all the way in. Make the last turn of the screw by hand. Install four rubber bumpers between second and third screws along long side of the floor. If plan to use shelf with shelf support post install fifth rubber bumper approximately where the post will be.

Cage top installation

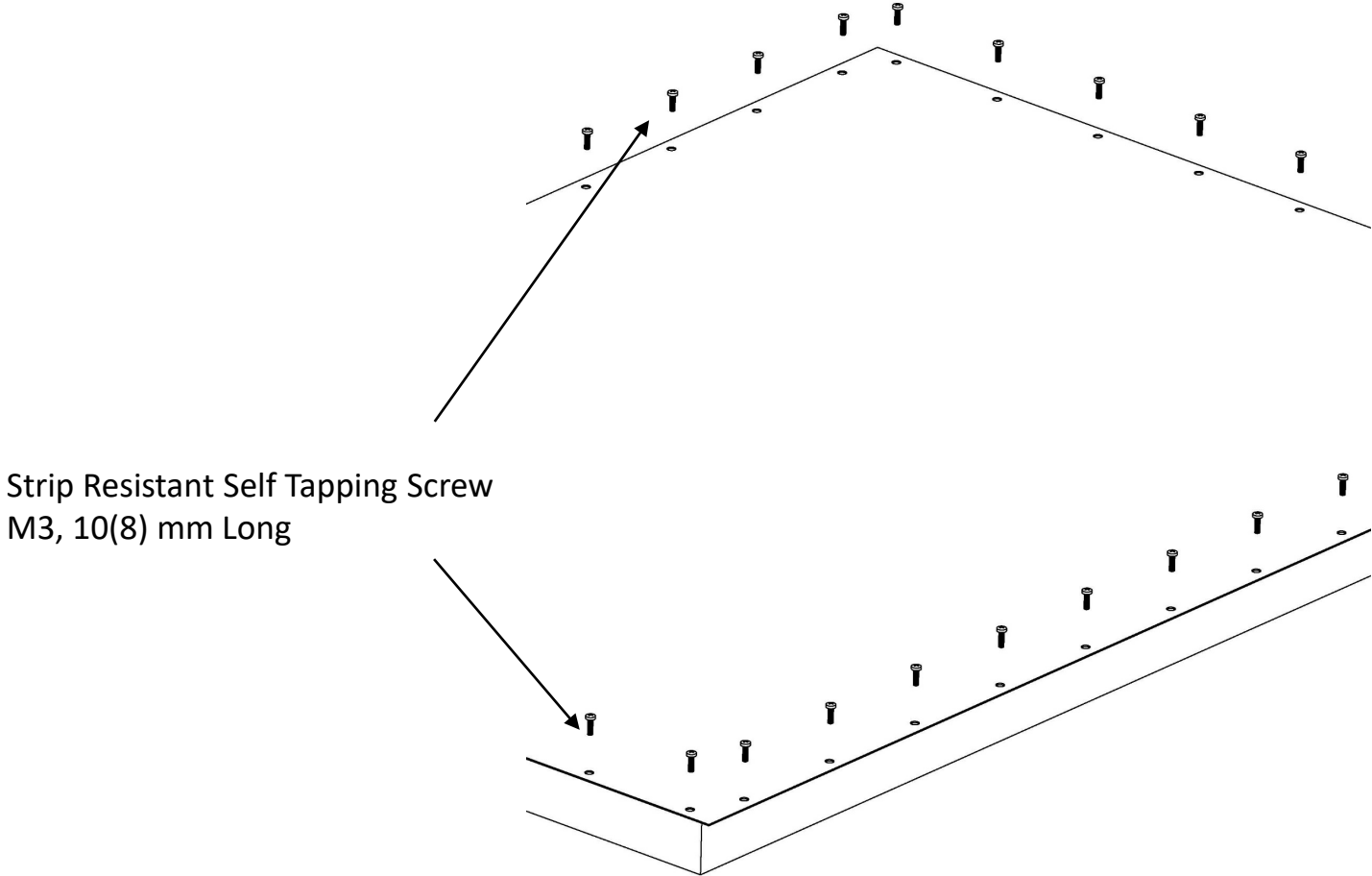

Strip Resistant Self Tapping Screw
M3, 10(8) mm Long

Install the top of the enclosure with its absorber foam facing the inside of the enclosure. Use self-tapping M3, 10(8)mm long screws. If use a hammer drill or impact driver to install screws, do NOT drive screws all the way in. Make the last turn of the screw by hand.

Door installation

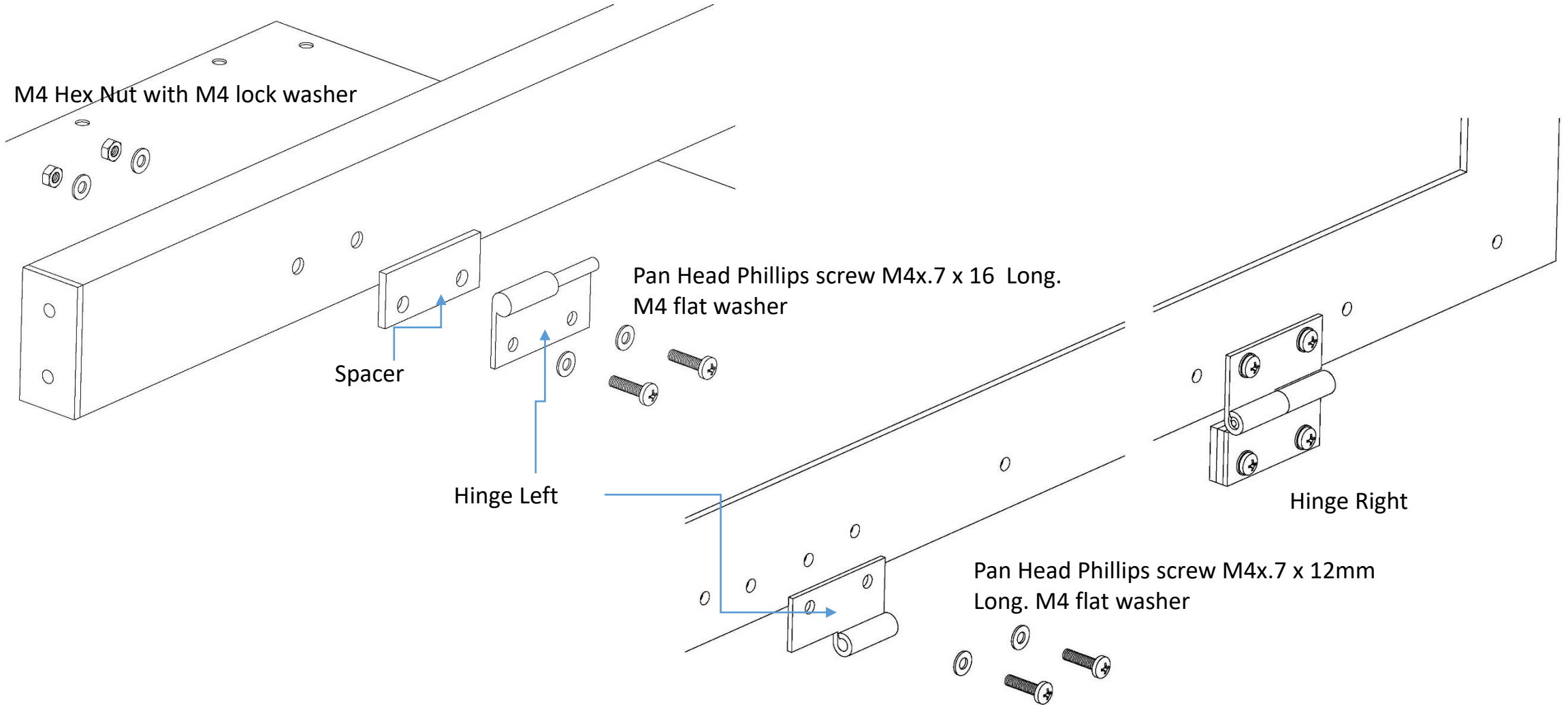

Install the hinge pins on the front-bottom frame bar. Use a 3-mm spacer between the bar and hinge. Make sure to use left-handed and right-handed hinge pins on the correct sides as shown. Do not tighten the screw yet. Turn the enclosure so that the front side faces up. Pick up the door and set it in position. Slide the hinge sockets onto the pin sockets. Fasten loosely with M4x12 screws. Adjust the door until it is in the correct location, then tighten all the screws.

Shelf installation (for customers who purchased FE with the shelf)

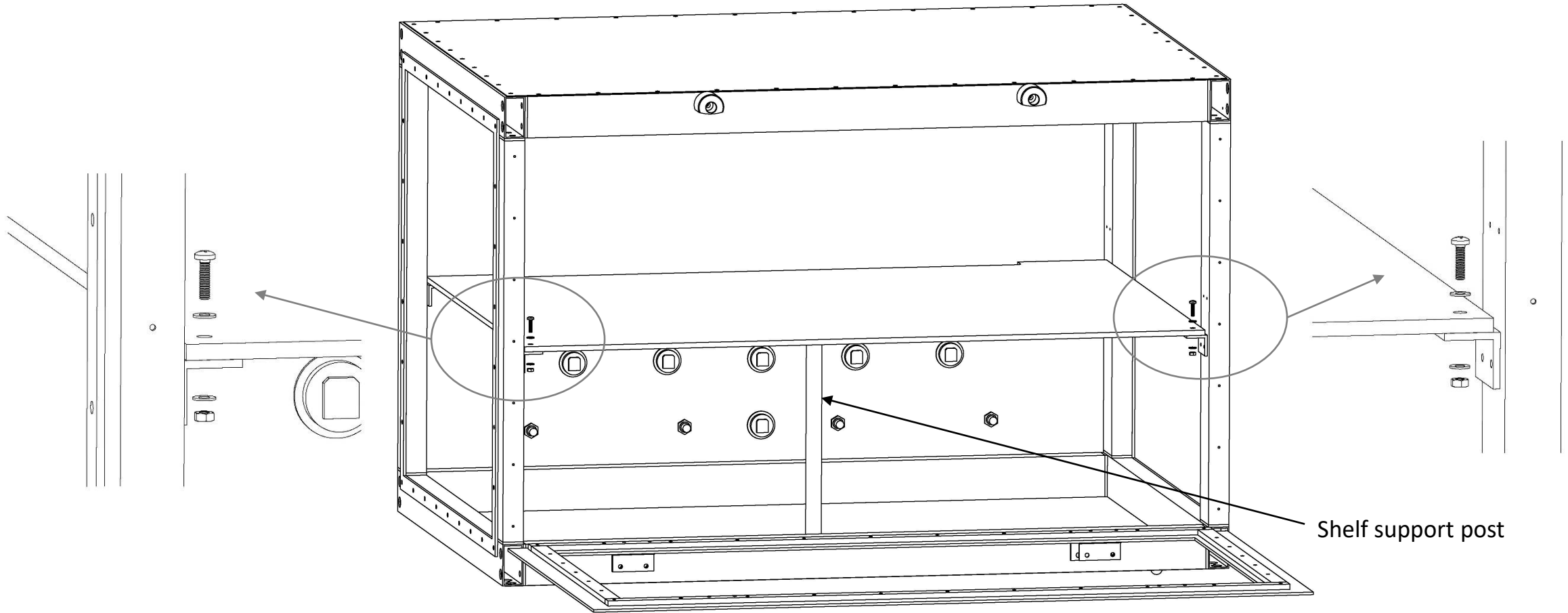

Slide in shelf and rest it on shelf brackets. Secure shelf to the front brackets with M5x 16 mm long screws, washers and nuts. To install shelf support post (optional) bring it in and slide to the desire location. Make sure there is an additional rubber bumper installed on the other side of the bottom (see page 6) within approximate location of the post.

Faraday enclosure assembled

