

8 7 6 5 4 3 2 1

REVISIONS		
REV.	DESCRIPTION	DATE
01	INITIAL RELEASE	2013 06 10
02	ADDED UNTHREADED PORTION	2013 06 11
03	UPDATED THREAD LENGTH	2013 06 12
04	INCREASED HEAD THICKNESS	2013 07 23
05	REMOVE SLOTTED DRIVE	2013 07 24

D
C
B
A

D
C
B
A

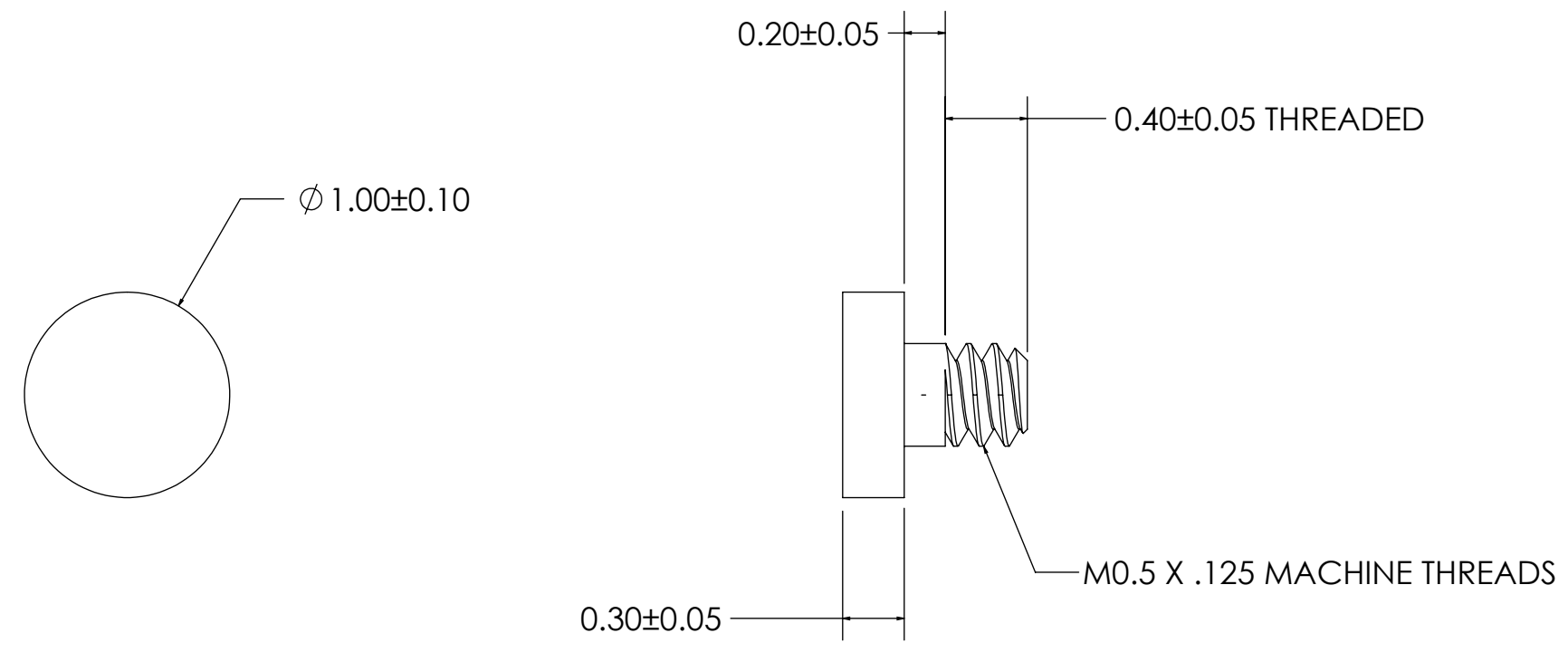
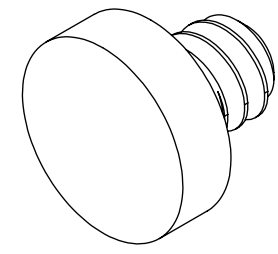

- PARTS MUST BE FREE OF BURRS OR LOOSE METAL CHIPS

DIMENSIONS ARE IN MM (INCHES) TOLERANCES: LINEAR ANGLE $\pm .05\text{MM}$ $X^\circ \pm 1^\circ$ $X.X^\circ \pm 0.5^\circ$		 www.usmicroscrew.com	
MATERIAL 303 STAINLESS STEEL		TITLE: M0.5 MACHINE SCREW	
FINISH NONE		SIZE B	DWG. NO. M05-05-M-SS-PS
		SCALE: 30:1	REV 05
		WEIGHT:	SHEET 1 OF 1

8 7 6 5 4 3 2 1