

ZONE	REV	DESCRIPTION	REVISIONS	DATE	APPROVED

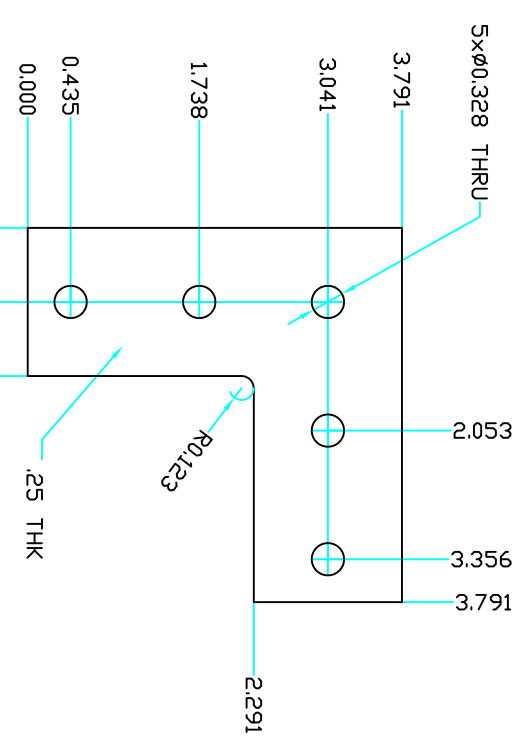
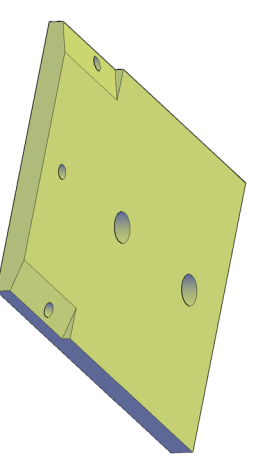
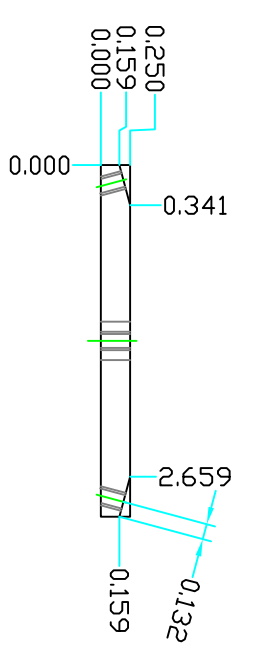
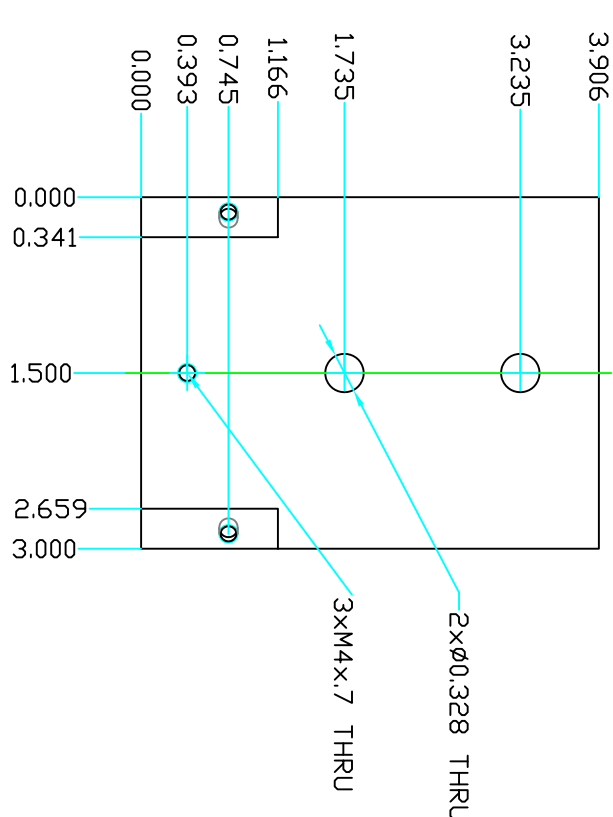
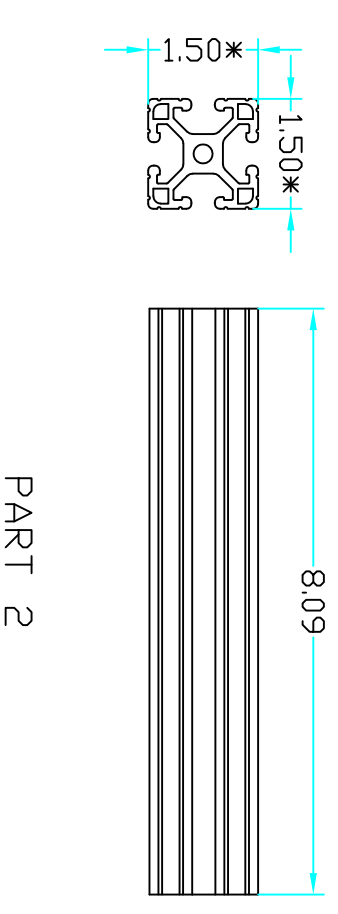

PART 4

PNUM/REV	QTY	UM	PART NAME	MATERIAL	PART DESCRIPTION	REF. SHEET/DWG.
PART 4	2	EA	PLATE	ALUMINUM 6061	4"x4", .25"THK PLATE	227.00.01.04
PART 3	4	EA	CORNER	ALUMINUM 6061	4"x4", .25"THK PLATE	227.00.01.03
PART 2	2	EA	FRAMING	ALUMINUM	T-Slotted Framing 15"x1.5", McMaster # 470651102	227.00.01.02
PART 1	2	EA	FRAMING	ALUMINUM	T-Slotted Framing 15"x1.5", McMaster # 470651102	227.00.01.01

UNLESS OTHERWISE SPECIFIED		PERMISSIBLE VARIATION IN INCH DIMENSIONS WITHOUT TOLERANCES	
1	DIMENSIONS ARE IN INCHES	FROM 0 TO 12	±0.10
2	MACHINE SURFACES TO BE FLAT, SQUARE, PARALLEL & CONCENTRIC	12 TO 60	±0.13
3	WITHIN .001 FEET 5 INCHES OR .001 TIR AS APPLICABLE	60 TO 180	±0.20
4	MARK ALL DETAILS EXCEPT COMMERCIAL PARTS WITH DWG.	180 TO 48	±0.005
5	ITEM NUMBER	48 TO 180	±0.010
6	BREAK ALL SHARP CORNERS .01" x 45° CHAMFER	OVER 180	±0.030
7	FILLET'S SHOWN SHARP = .04" RADIUS		±0.015
8	FILLET'S SHOWN BEVEL = .04" RADIUS		±0.010
9	CSKING BEVELS, BEVELD HOLES 1/16" x 45°		±0.010
10	ALL WELDING TO CONFORM TO LATEST AWS STANDARDS		

SURFACE TEXTURE $\sqrt{32}$
TOLERANCES ARE NOT ACCUMULATIVE

DATE	BY	CHKD	APPD	TITLE	DRAWING NUMBER	REVISION
05/09/22	AD	KH		DFPS SETUP 4X4 FRAME PARTS	227.00.01.00	1 DF 1

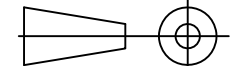

DATE	BY	CHKD	APPD	TITLE	DRAWING NUMBER	REVISION
05/09/22	AD	KH		DFPS SETUP 4X4 FRAME PARTS	227.00.01.00	1 DF 1

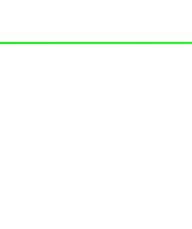

6 5 4 3 2 1